



12. THE CONTRACTOR SHALL ENACT ALL MEASURES TO PROTECT AND SAFEGUARD WORKERS AND THE GENERAL PUBLIC FROM INJURY DURING THE ENTIRE TIME OF CONSTRUCTION. MAINTAIN THE JOB SITE IN AN ORDERLY, CLEAN MANNER THROUGHOUT THE COURSE OF CONSTRUCTION. PREPARE AND MAINTAIN A SAFE WORKING ENVIRONMENT. LEAVE NO DEBRIS, EXCESS MATERIALS OR DEBRIS AT THE END OF EACH DAY, AND COMPLY WITH ALL APPLICABLE CODES. ALL CONTRACTORS AND SUBCONTRACTORS SHALL COMPLY WITH THE OCCUPATIONAL SAFETY AND HEALTH REGULATIONS OF THE U.S. DEPARTMENT OF LABOR AND THE STATE OF CALIFORNIA, DEPARTMENT OF INDUSTRIAL RELATIONS' "CONSTRUCTION SAFETY ORDERS". THE CITY ENGINEER SHALL NOT BE RESPONSIBLE IN ANY WAY FOR THE CONTRACTORS AND SUBCONTRACTORS COMPLIANCE WITH THE OCCUPATIONAL SAFETY AND HEALTH REGULATIONS OF THE U.S. DEPARTMENT OF LABOR OR WITH THE STATE OF CALIFORNIA, DEPARTMENT OF INDUSTRIAL RELATIONS' "CONSTRUCTION SAFETY ORDERS". THE CONTRACTOR SHALL DEFEND, INDEMNIFY AND HOLD THE OWNER AND THE ENGINEER HARMLESS FROM ANY AND ALL LIABILITY, REAL OR ALLEGED, IN CONNECTION WITH THE PERFORMANCE OF WORK ON THIS PROJECT, EXCEPT FOR LIABILITY ARISING FROM THE SOLE NEGLIGENCE OF THE OWNER OR THE ENGINEER.
13. ALL CONCRETE AND ASPHALT CONCRETE PAVEMENT TO BE REMOVED SHALL BE REMOVED UTILIZING A SAW CUT (MINIMUM CUT DEPTH 1 1/2 INCHES) AND/OR OTHER METHODS AS APPROVED BY THE CITY ENGINEER.
14. CONTRACTOR SHALL POT HOLE TO VERIFY LOCATION AND DEPTH OF UTILITIES.
15. THE CONTRACTOR SHALL ADJUST ALL UTILITY VALVE BOXES, MANHOLES, ETC. TO GRADE UPON COMPLETION OF PAVING. CONCRETE PAVEMENT SHALL BE USED TO PATCH AROUND RASED UTILITIES IN CONCRETE STREETS. ASPHALT CONCRETE PAVEMENT IN ASPHALT CONCRETE STREETS, IF PULLBOXES (WATER, GAS ETC.) ARE DAMAGED, CONTRACTOR SHALL REPLACE THEM IN KIND.
16. EXISTING UTILITIES SHALL BE MAINTAINED IN PLACE BY THE CONTRACTOR. UNLESS OTHERWISE NOTED, RELOCATION, REMOVAL OF ANY EXISTING UTILITIES NOT COVERED BY THESE PLANS SHALL BE PERFORMED BY OR UNDER THE DIRECTION OF THE RESPECTIVE UTILITY OWNERS AT THE EXPENSE OF THE CONTRACTOR.
17. CONTRACTOR SHALL PROTECT IN PLACE ANY VAL BOXES, IRRIGATION SYSTEM, ELECTRICAL CONDUIT, CABLE CONDUIT OR UTILITY LINE, IF DAMAGED DURING CONSTRUCTION. CONTRACTOR SHALL REPAIR IN KIND.
18. THE CONTRACTOR SHALL REPLACE IN KIND TO THE SATISFACTION OF THE CITY ENGINEER, ANY PAVING, CURB AND GUTTER OR OTHER IMPROVEMENTS CUT, REMOVED, OR DAMAGED IN CONJUNCTION WITH THIS PROJECT.
19. THE CONTRACTOR AGREES THAT HE SHALL ASSUME SOME OF THE COMPLETE RESPONSIBILITY FOR JOB SITE CONDITIONS DURING THE COURSE OF CONSTRUCTION OF THIS PROJECT, INCLUDING SAFETY OF ALL PERSONS AND PROPERTY. THAT THIS REQUIREMENT SHALL INCLUDE, BUT NOT BE LIMITED TO, THE CONTRACTOR SHALL DEFEND, INDEMNIFY AND HOLD THE CITY, THE CITY ENGINEER, AND THEIR REPRESENTATIVE, HARMLESS FROM ANY AND ALL LIABILITY, REAL OR ALLEGED, IN CONNECTION WITH THE PERFORMANCE OF WORK ON THIS PROJECT, EXCEPT FOR LIABILITY ARISING FROM THE SOLE NEGLIGENCE OF THE CITY OR THE CITY ENGINEER.

[illegible]

SUBMITTED BY: _____

MANUEL FABIAN, CIVIL ENGINEERING ASSISTANT II

REVIEWED BY: _____

DATE: _____

APPROVED BY: _____

PUBLIC WORKS DEPARTMENT

MATTHEW BAYKOWITZ, P.E., DIRECTOR OF PUBLIC WORKS, RCE 71932

DATE: _____





SPW/C NO.	TITLE
110-2	DRIVEWAY APPROACHES
111-5	CURE RAMP
112-2	CURE & SIDEWALK JOINTS
113-2	SIDEWALK AND DRIVEWAY REPLACEMENT
120-2	CURB AND GUTTER/BARRIER
122-2	CROSS AND LONGITUDINAL GUTTERS
132-3	CONCRETE PAVEMENT REPLACEMENT
133-3	ASPHALT CONCRETE PAVEMENT REPLACEMENT
205-2	SEWER MANHOLE ADJUSTMENT
206-2	MANHOLE RAISING RINGS

CONTRACTOR TO OBTAIN CURRENT AGENCY STANDARD
PLANS PRIOR TO START OF CONSTRUCTION

UTILITY	TITLE
WATER	CITY OF SAN FERNANDO 120 MACENEL STREET, SAN FERNANDO, CA 91340 (618) 889-1213
SCE	1000 POTRERO GRANDE DRIVE MADERA, CA 91768 CONTACT: ELIAS BERNIMDEZ (323) 720-9269
SGC	THE GAS COMPANY 9400 OKADALE, CHATSWORTH, CA 91311-6511 CONTACT: MICHAEL DUENAS (714) 634-7265
CHARTER COMMUNICATIONS	9410 JORDAN AVE CHATSWORTH, CA 91311 CONTACT: SHAWN RIGGS (818) 407-3152
AJT	8683 GRAND AVENUE SAN FERNANDO, CA 91770 CONTACT: STEVE GILLESPIE (626) 597-7193
PLAINS ALL AMERICAN PIPELINE (PAA)	5900 CHERY AVE LONG BEACH, CA 90805 CONTACT LINE RIDER SUPERVISOR: DAVID DELGADO (562) 726-2054

- | | | | |
|-----|---|--------------|--|
| 20. | THE CONTRACTOR SHALL PROVIDE DUST CONTROL AND TRAFFIC CONTROL AT ALL TIMES TO THE SATISFACTION OF THE CITY ENGINEER, DISTRICT ENGINEER, DISTRICT SUPERVISOR, DISTRICT ASSESSOR, DISTRICT MANAGEMENT DISTRICT (A.O.M.D.) RULE 403 FOR MITIGATING DUST CONTROL. | SHEET 1 OF 5 | TITLE SHEET |
| 21. | BARRICADES WITH FLASHING LIGHTS ARE TO BE MAINTAINED ON ALL TIMES. CONSTRUCTION WARNING SIGNS AND FLAGMEN ARE TO BE PRESENT AT THE JOB SITE. | 2 OF 5 | STREET PLANS |
| 22. | THE CONTRACTOR SHALL NOTIFY UNDERGROUND SERVICE ALERT AT | 3 OF 9 | POCO STREET CONSTRUCTION PLAN - STA 12+25 TO 18+10 |
| | | 4 OF 9 | POCO STREET - STA 0+00 TO 11+00 |
| | | 5 OF 9 | POCO STREET - STA 11+00 TO 18+50 |
| | | | STRING PLANS |

SPW/C NO.	TITLE
110-2	DRIVEWAY APPROACHES
111-5	CURB RAMP
112-2	CURB & SIDEWALK JOINTS
113-2	SIDEWALK AND DRIVEWAY REPLACEMENT
120-2	CURB AND GUTTER-BARRIER
122-2	CROSS AND LONGITUDINAL GUTTERS
123-3	CONCRETE PAVEMENT REPLACEMENT
133-3	ASPHALT CONCRETE PAVEMENT REPLACEMENT
205-2	SEWER MANHOLE ADJUSTMENT
206-2	MANHOLE PAISING RINGS

CONTRACTOR TO OBTAIN CURRENT AGENCY STANDARD
PLANS PRIOR TO START OF CONSTRUCTION

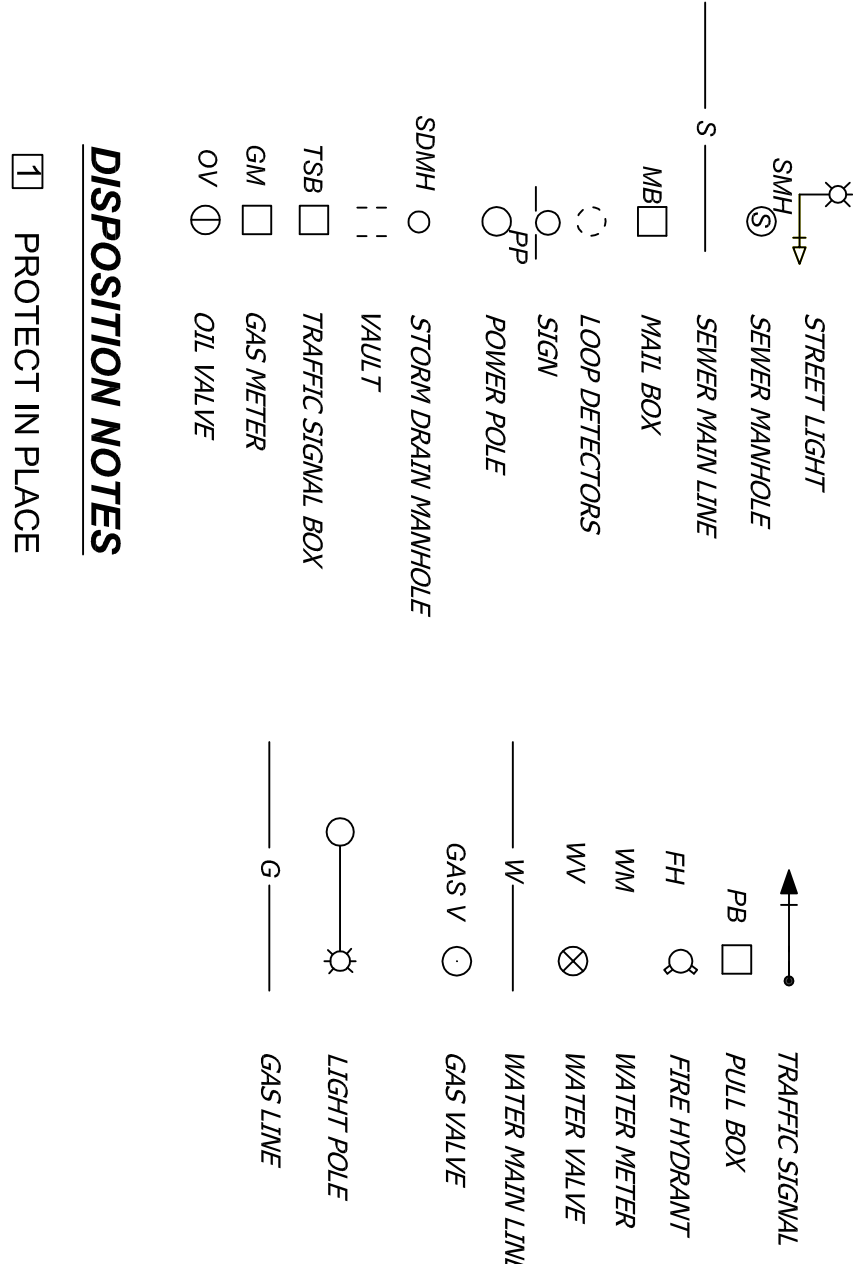

1 PROTECT IN PLACE

1 PROTECT IN PLACE

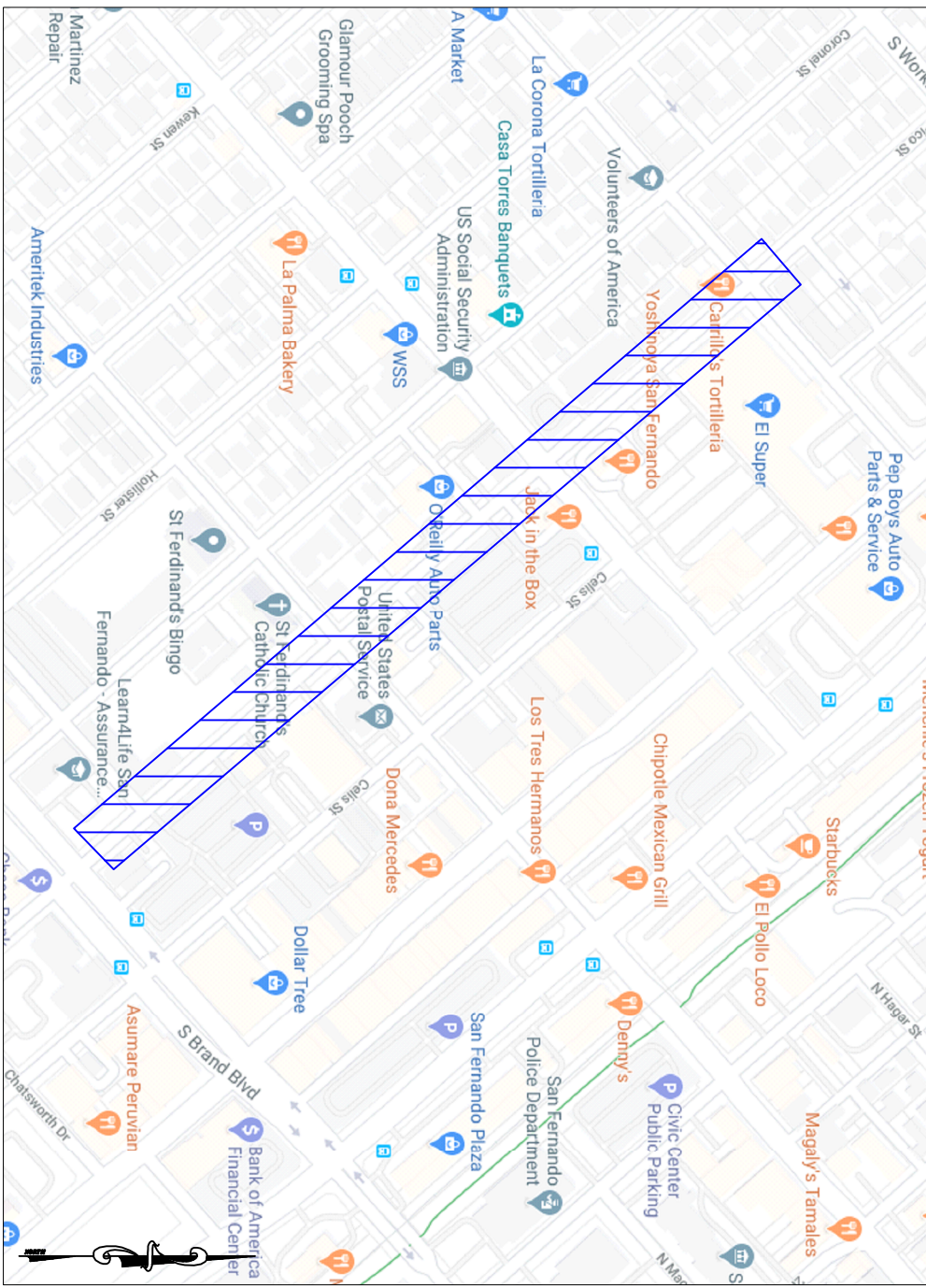

LOCATION MAP

N.T.S

CDBG PROJ. NO. 602080-19, JOB NO. 7610	PLAN NO.
PICO STREET IMPROVEMENT PROJECT From Kalisher Street To Brand Boulevard	P-731
CITY OF SAN FERNANDO	SHEET 1 OF 5

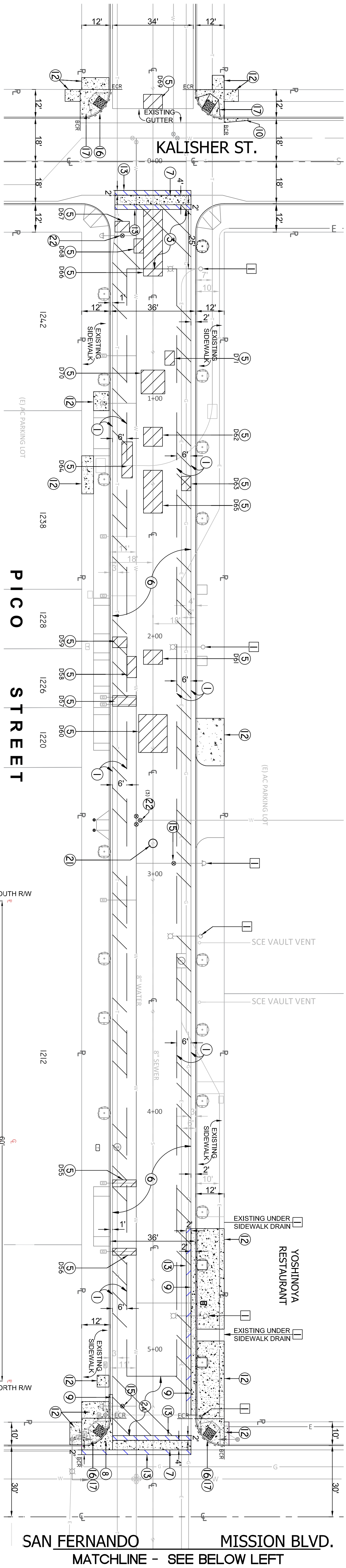

SAN FERNANDO MISSION BLVD.
MATCHLINE - SEE BELOW LEFT

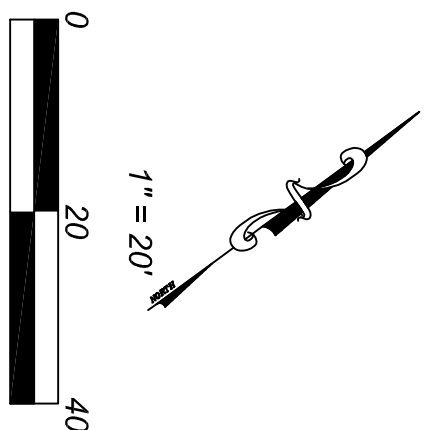

TYPICAL SECTION

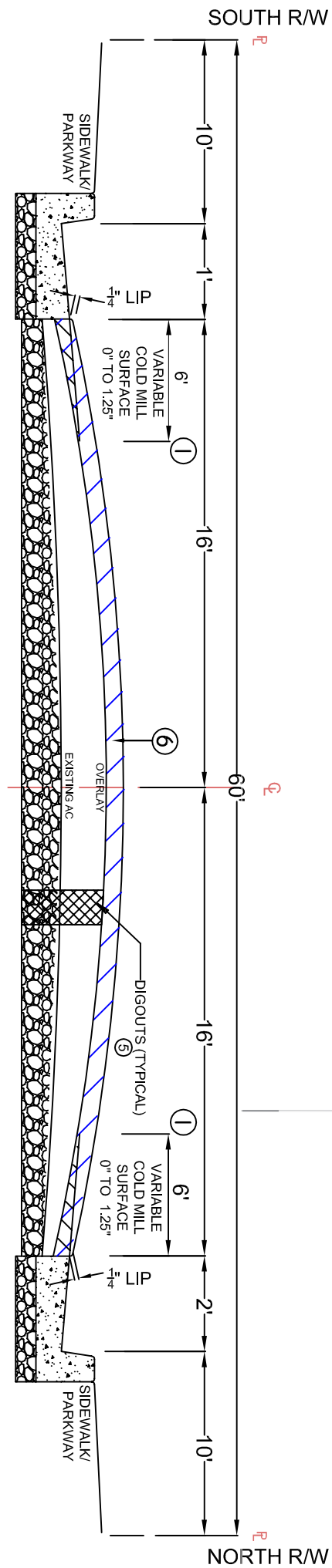

PICO STREET BETWEEN KALISHER STREET AND SAN FERNANDO MISSION BOULEVARD

- ① VARIABLE COLD MILL (0 IN. TO 1.25 IN.).
- ② VARIABLE COLD MILL (0 IN. TO 1.50 IN.).
- ③ TRANSVERSE VARIABLE COLD MILL (0 IN. TO 1.25 IN.).
- ④ VARIABLE COLD MILL (1.25 IN. TO 1.50 IN.).
- ⑤ AC DSG-OUTS (8 IN.).
- ⑥ AC PAVEMENT OVERLAY, 1.5 IN. ARHMA.
- ⑦ REMOVE AND REPLACE PCC X-GUTTER.
- ⑧ REMOVE AND REPLACE PCC SPANDREL.
- ⑨ REMOVE AND REPLACE PCC CURB AND GUTTER (8 IN./24 IN.).
- ⑩ REMOVE AND REPLACE PCC GUTTER ONLY (24 IN.).
- ⑪ REMOVE AND REPLACE PCC DRIVE APPROACH (6 IN.).
- ⑫ REMOVE AND RECONSTRUCT PCC SIDEWALK (4 IN.).
- ⑬ CONSTRUCT AC SLOT TRENCHES.
- ⑭ REMOVE AND RECONSTRUCT THROUGH THE CURB DRAIN.
- ⑮ REPAIR TOP OF THROUGH THE CURB DRAIN.

DISPOSITION NOTES

① PROTECT IN PLACE

DISPOSITION NOTES

1 PROTECT IN PLACE

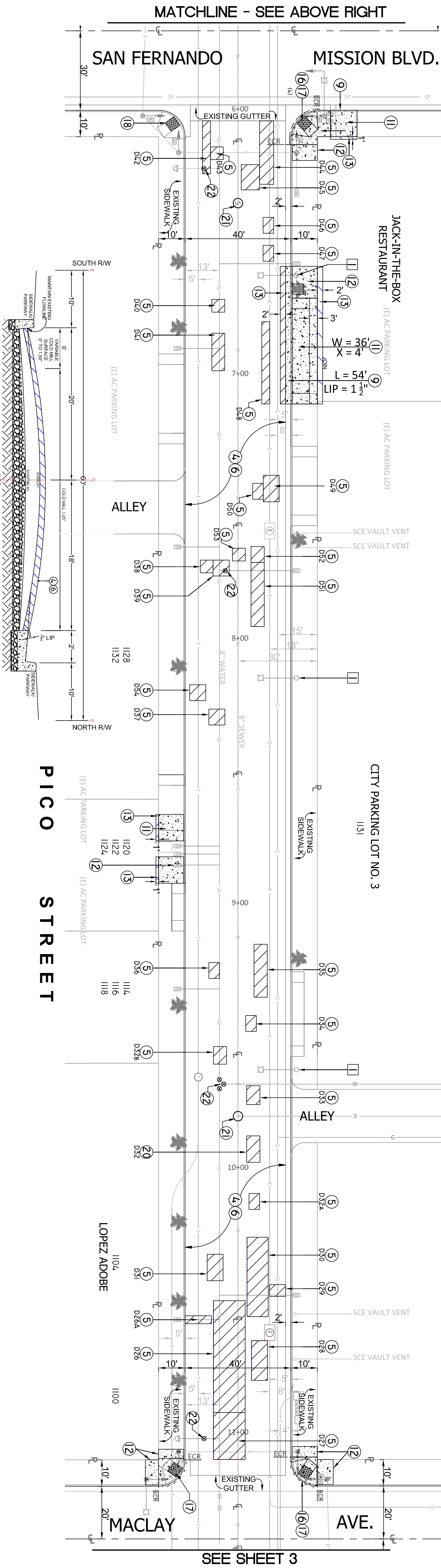

SEE SHEET 3

811 Know what's below. Call before you dig.					
R E V I S I O N S					
NUMBER	DATE	INITIALS	DESCRIPTION	APPROVED	
SUBMITTED BY: MANUEL FABIAN, CIVIL ENGINEERING ASSISTANT II					
DATE _____					
PUBLIC WORKS DEPARTMENT					
EMILIO M. MURGA, CONSULTANT CITY ENGINEER, ROC 54-420					
DATE _____					
					
CDBG PROJ. NO. 602080-19, JOB NO. 7610					
PLAN NO.					
PICO STREET IMPROVEMENT PROJECT (From Kalisher Street To Brand Boulevard)					
CITY OF SAN FERNANDO					
SHEET 2 OF 5					

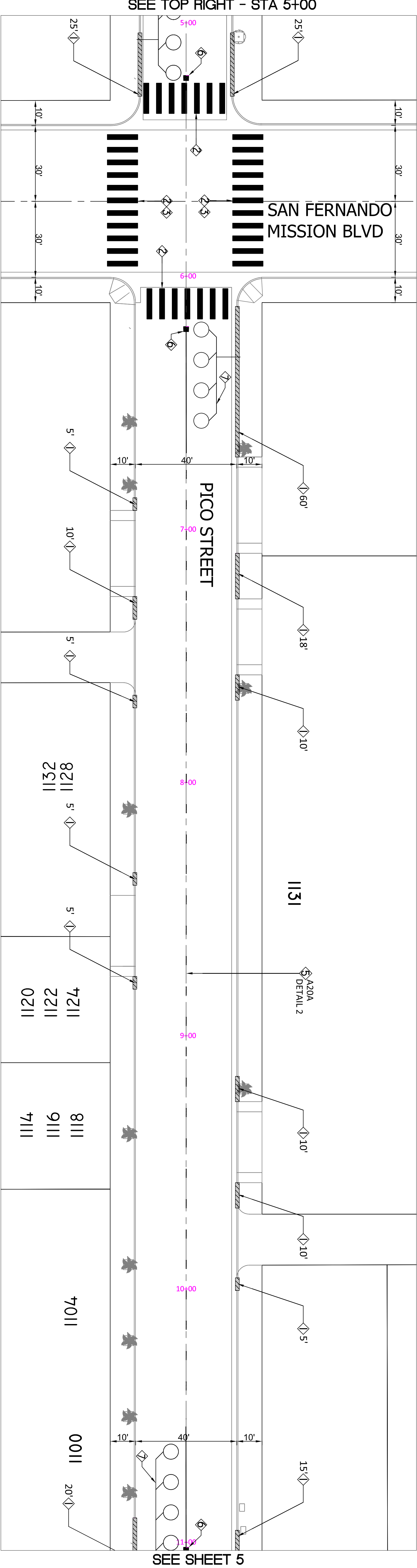
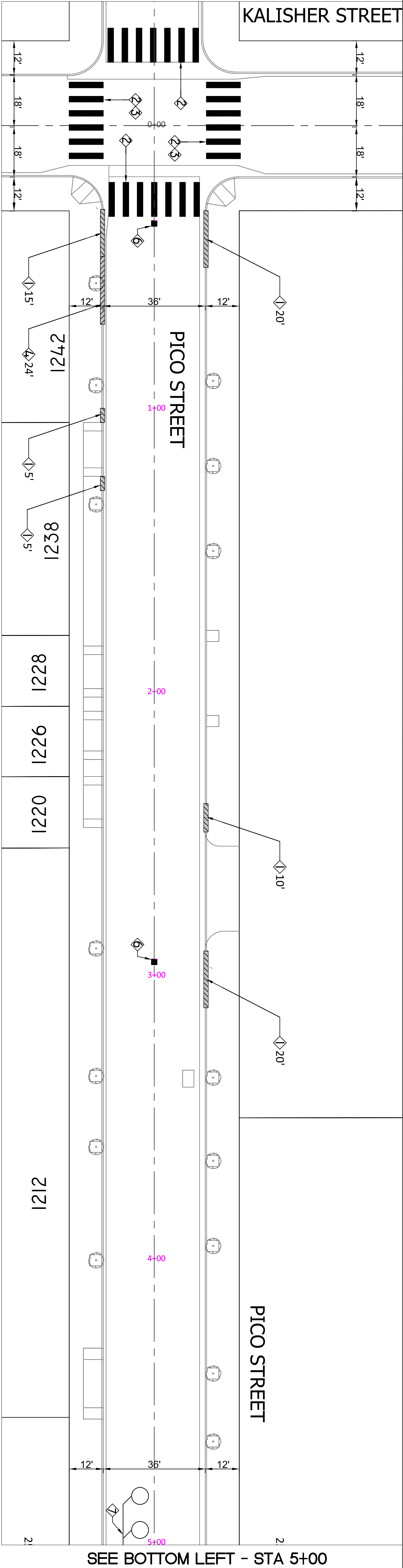

GENERAL NOTES

1. TRAFFIC SIGNING AND STRIPING SHALL CONFORM TO THE CALTRANS STANDARD PLANS AND SPECIFICATIONS, DATED 2015, THE CALIFORNIA MANUAL ON UNIFORM TRAFFIC CONTROL DEVICES (CA MUTCD), DATED 2014, THESE PLANS AND THE SPECIAL PROVISIONS.
2. ALL STRIPING DETAILS, PAVEMENT MARKINGS AND CROSSWALKS SHALL BE THERMOPLASTIC. CURB MARKINGS SHALL BE PAINT, 2 COATS.
3. CONTRACTOR SHALL REPAINT ALL EXISTING CURB ADDRESS NUMBERS WITHIN THE PROJECT LIMITS.
4. ALL EXISTING CURB MARKINGS WITHIN THE PROJECT LIMITS SHALL BE REPAINTED.
5. CONFLICTING STRIPING AND PAVEMENT LEGENDS SHALL BE REMOVED. REMOVAL OF CONFLICTING STRIPING AND PAVEMENT MARKINGS SHALL BE BY WET SANDBLASTING FOR PAINT AND/OR GRINDING FOR THERMOPLASTIC. STRIPING REMOVALS SHALL INCLUDE REMOVING RAISED PAVEMENT MARKERS.

CONSTRUCTION NOTES

- PAINT RED CURB, LENGTH AS NOTED.
- INSTALL CROSSWALK, PER CALTRANS STANDARD A24F. CENTER MARKINGS SHALL BE INSTALLED SUCH THAT WHEELS STRADDLE THE CROSSWALK MARKINGS.
- REMOVE CONFLICTING STRIPING BY WET SANDBLASTING FOR PAINT AND/OR GRINDING FOR THERMOPLASTIC.
- PAINT GREEN CURB, LENGTH AS NOTED.
- INSTALL STRIPING DETAIL OR PAVEMENT MARKING AS NOTED.
- INSTALL TWO-WAY REFLECTIVE MARKER AT FIRE HYDRANT.
- INSTALL INDUCTIVE DETECTOR LOOPS, 6" DIAMETER TYPE "E" AND CENTERED ON TRAVEL LANE.

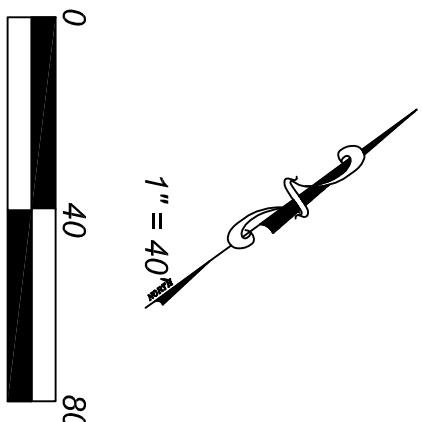

R E V I S I O N S			DESCRIPTION		APPROVED
NUMBER	DATE	INITIALS			

SUBMITTED BY:		PUBLIC WORKS DEPARTMENT	
MANUEL FABIAN, CIVIL ENGINEERING ASSISTANT II			
DATE		DATE	

CDBG PROJ. NO. 602080-19, JOB NO. 7610		PLAN NO.	
STRIPING PLAN		P-731	
PICO STREET IMPROVEMENT PROJECT		From Kalisher Street To Brand Boulevard	
CITY OF SAN FERNANDO		SHEET 4 OF 5	

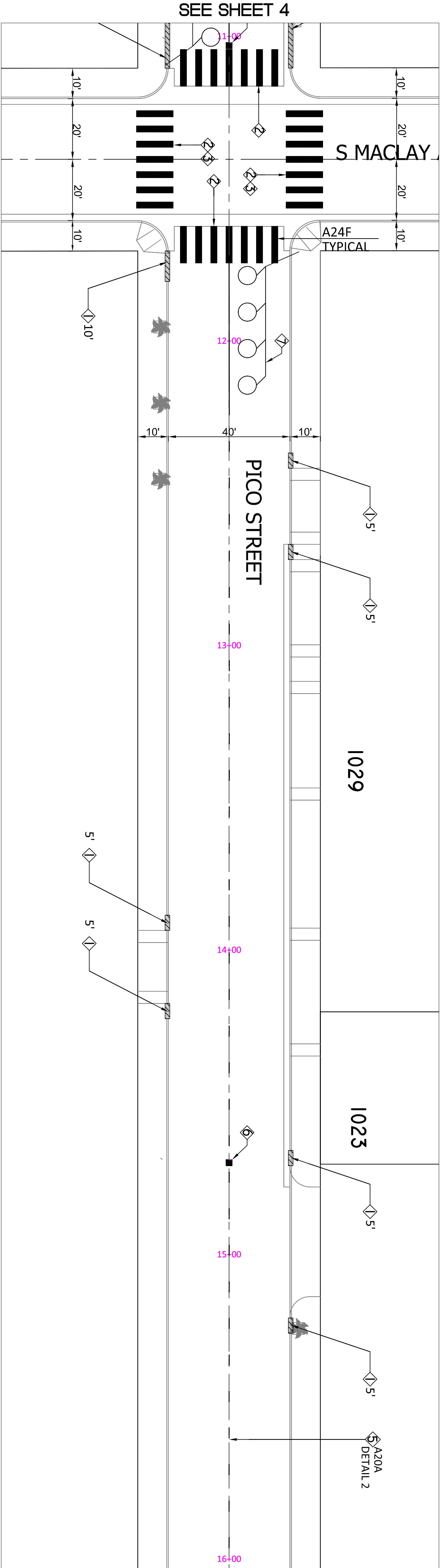

SEE BOTTOM LEFT - STA 16+00

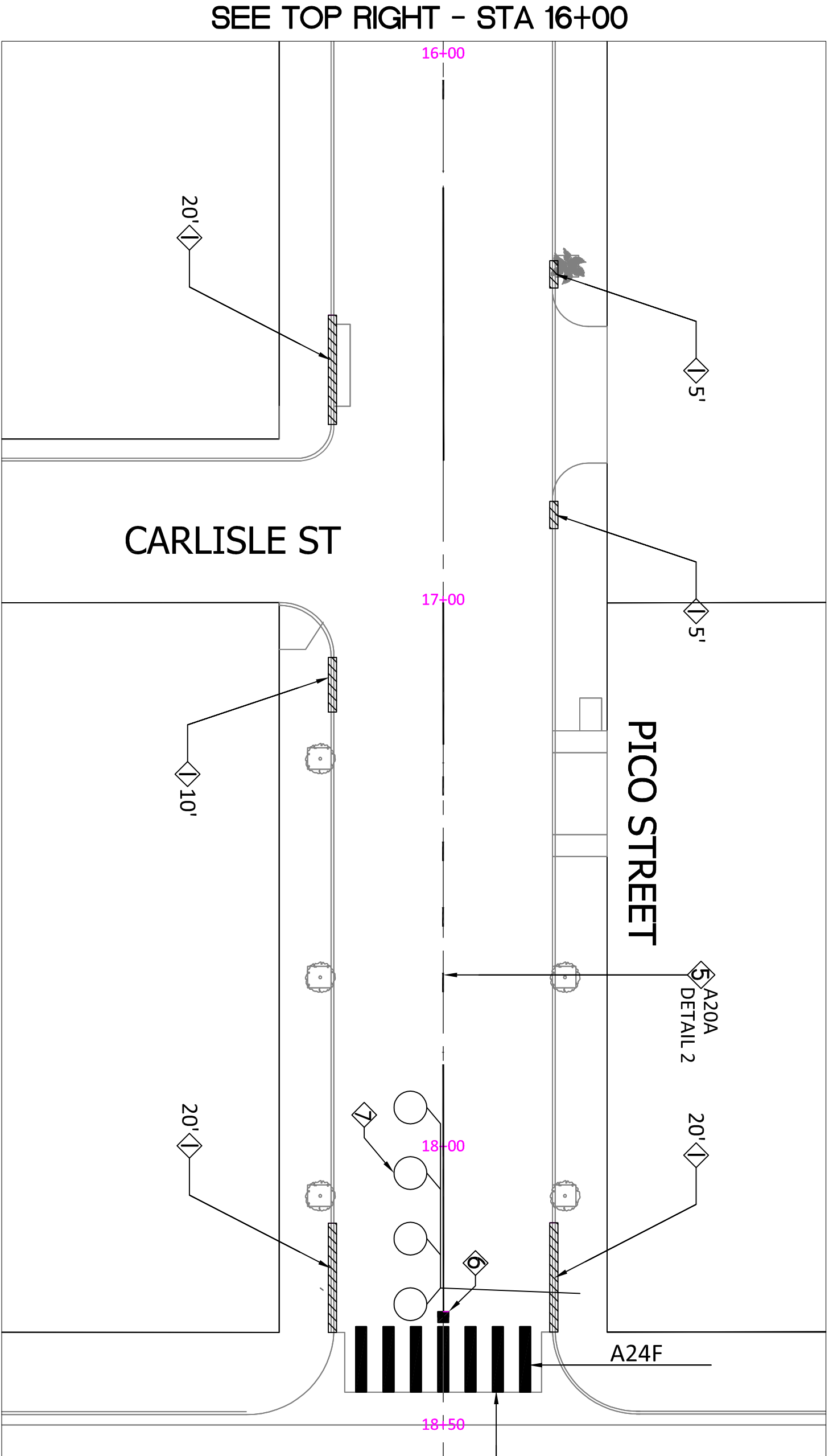

SEE TOP RIGHT - STA 16+00

GENERAL NOTES

1. TRAFFIC SIGNING AND STRIPING SHALL CONFORM TO THE CALTRANS STANDARD PLANS AND SPECIFICATIONS, DATED 2015, THE CALIFORNIA MANUAL ON UNIFORM TRAFFIC CONTROL DEVICES (CA MUTCD), DATED 2014, THESE PLANS AND THE SPECIAL PROVISIONS.
2. ALL STRIPING, DETAILS, PAVEMENT MARKINGS AND CROSSWALKS SHALL BE THERMOPLASTIC. CURB MARKINGS SHALL BE PAINT, 2 COATS.
3. CONTRACTOR SHALL REPAINT ALL EXISTING CURB ADDRESS NUMBERS WITHIN THE PROJECT LIMITS.
4. ALL EXISTING CURB MARKINGS WITHIN THE PROJECT LIMITS SHALL BE REPAINTED.
5. CONFLICTING STRIPING AND PAVEMENT LEGENDS SHALL BE REMOVED. REMOVAL OF CONFLICTING STRIPING AND PAVEMENT MARKINGS SHALL BE BY WET SANDBLASTING FOR PAINT AND/OR GRINDING FOR THERMOPLASTIC. STRIPING REMOVALS SHALL INCLUDE REMOVING RAISED PAVEMENT MARKERS.

CONSTRUCTION NOTES

1. PAINT RED CURB, LENGTH AS NOTED.
2. INSTALL CROSSWALK, PER CALTRANS STANDARD A24F. CENTER MARKINGS SHALL BE INSTALLED SUCH THAT WHEELS STRADDLE THE CROSSWALK MARKINGS.
3. REMOVE CONFLICTING STRIPING BY WET SANDBLASTING FOR PAINT AND/OR GRINDING FOR THERMOPLASTIC.
4. PAINT GREEN CURB, LENGTH AS NOTED.
5. INSTALL STRIPING DETAIL OR PAVEMENT MARKING AS NOTED.
6. INSTALL TWO-WAY REFLECTIVE MARKER AT FIRE HYDRANT.
7. INSTALL INDUCTIVE DETECTOR LOOPS, 6" DIAMETER TYPE "E" AND CENTERED ON TRAVEL LANE.

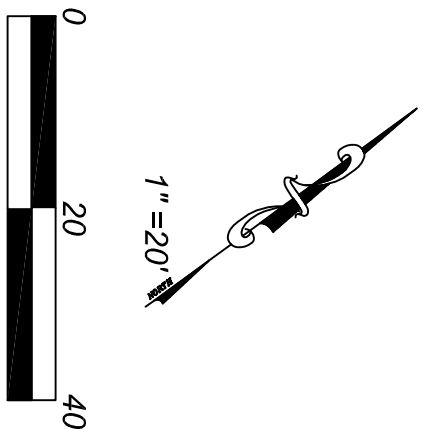

R E V I S I O N S			
NUMBER	DATE	INITIALS	DESCRIPTION

SUBMITTED BY:		DATE	
MANUEL FABIAN, CIVIL ENGINEERING ASSISTANT II			
PUBLIC WORKS DEPARTMENT		DATE	

CDBG PROJ. NO. 602080-19, JOB NO. 7610		PLAN NO.	
STRIPING PLAN			
PICO STREET IMPROVEMENT PROJECT		P-731	
From Kalisher Street To Brand Boulevard			
CITY OF SAN FERNANDO		SHEET 5 OF 5	